

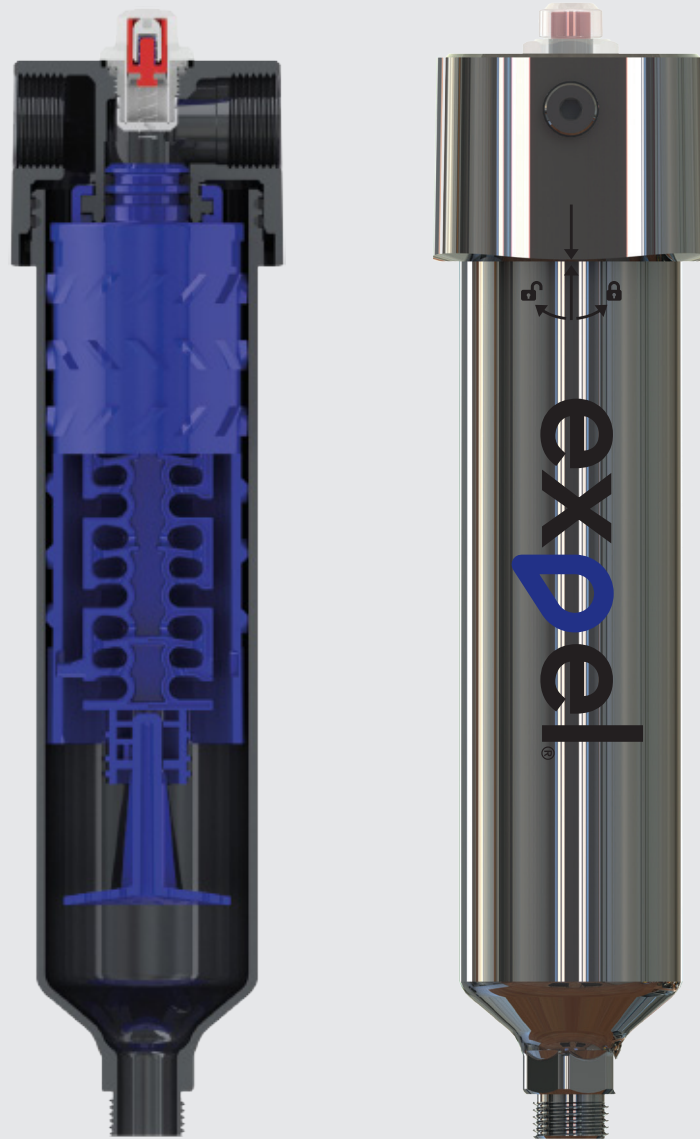

// ONE BRAND // ONE SOURCE // ONE SYSTEM



INTRODUCTORY OFFER  
**£225.00+VAT**



// SERVICE // MATERIAL PROCESSING // SURFACE PROTECTION // AUTOMOTIVE

## EXPEL 30

Point of use liquid water, oil and particulate compressed air filter



## EXPEL 30 - POINT OF USE LIQUID WATER, OIL & PARTICULATE COMPRESSED AIR FILTER

### Exceptional compressed air quality guaranteed

Expel will dramatically improve compressed air systems throughout the industry. The unique patented design allows it to efficiently remove **99.9999%** of liquid, oil, water and removes other contaminants down to 1 micron when installed at point of use.



## Expel 30

### PRODUCT OVERVIEW

- 30 cfm max rated flow rate
- 15 bar(g) - 217 psi(g) maximum pressure
- **5 year manufacturer's warranty**
- ½" & ¾" BSPT / NPT inlet / outlet connections
- Removes 99.9999% all liquid water, oils, and filters particulates down to 1 micron
- Grade 304 stainless steel body and head
- Pressure indicator as standard
- Optional pressure gauge.
- ½" BSPT / NPT male drain port

### FEATURES

- Tested to ISO 12500 - part 3 & 4 standard
- Worlds first cleanable, reusable compressed air filter
- No increase in pressure drop caused by contaminated filters
- No power source required
- Significantly reduced life cycle costs
- Easy to install & maintain
- Instantaneous recovery from pulsed flows or stop start
- All spare parts available
- Fully dismantlable
- No decrease in performance over lifetime of well maintained filter

## EXPEL

POINT OF USE LIQUID WATER, OIL & PARTICULATE  
COMPRESSED AIR FILTER



### OPERATIONAL SPECIFICATION

	0.14 - 0.85m <sup>3</sup> /min
Flow rate for a 7 bar(g) system	8.5 - 51 m <sup>3</sup> /hr
	5 - 30 cfm
	141 - 850 litres/min
Operating pressure	1 - 15 bar(g)
	15 - 217 psi(g)
Operating temperature	>0 to +80 °C
	>32 to 176 °F
Maximum recommended inlet temperature	35 °C
	95 °F

### MECHANICAL SPECIFICATION

Product code - 1/2"	6000-002-AA
Product code - 3/4"	6000-003-AA
Inlet/Outlet connection	1/2" or 3/4" BSPT/NPT
Drain connection	1/2" (m) BSPT/NPT
Weight	2.08 kg
Product dimensions	293 mm x 80 mm
Particulate removal	> 1 micron
Material (housing)	Stainless Steel 304
Material (internal)	ABS

### PRODUCT LINE DRAWING



\*Not to scale

### LINE DRAWING FOR MOUNTING

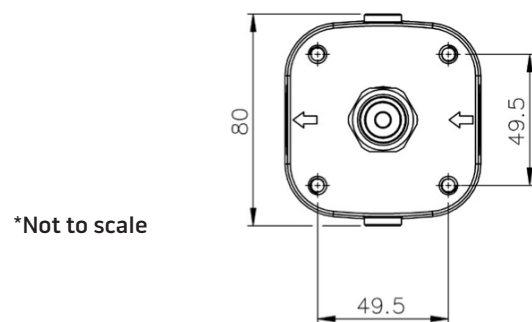

\*Not to scale

### BOX CONTENTS

### QTY

Expel 30 Unit	1
Mounting bracket	1
Bolts M6 x 8 mm	4
Fixing Screws	4
Wall Plugs	4
Manual	1



**WINNERS 2014, 2015, 2016**



Your local contact



**// ONE BRAND // ONE SOURCE // ONE SYSTEM**

- // SERVICE
- // MATERIAL PROCESSING
- // SURFACE PROTECTION
- // AUTOMOTIVE

**REMA TIP TOP AUTOMOTIVE UK LIMITED**  
Westland Square · Leeds · West Yorkshire · LS11 5XS  
Phone: +44 (0)113 277 0044  
Fax: +44 (0)113 277 2139  
info@tip-top.co.uk  
[www.rema-tiptop.co.uk](http://www.rema-tiptop.co.uk)



Printed in United Kingdom

